

PREMIUM SELF ADHESIVE

PDO POLY

WATERPROOF MEMBRANE / UNDERLAY / ISOLATION BARRIER

INSTALLATION GUIDE

Scyon Sheeting

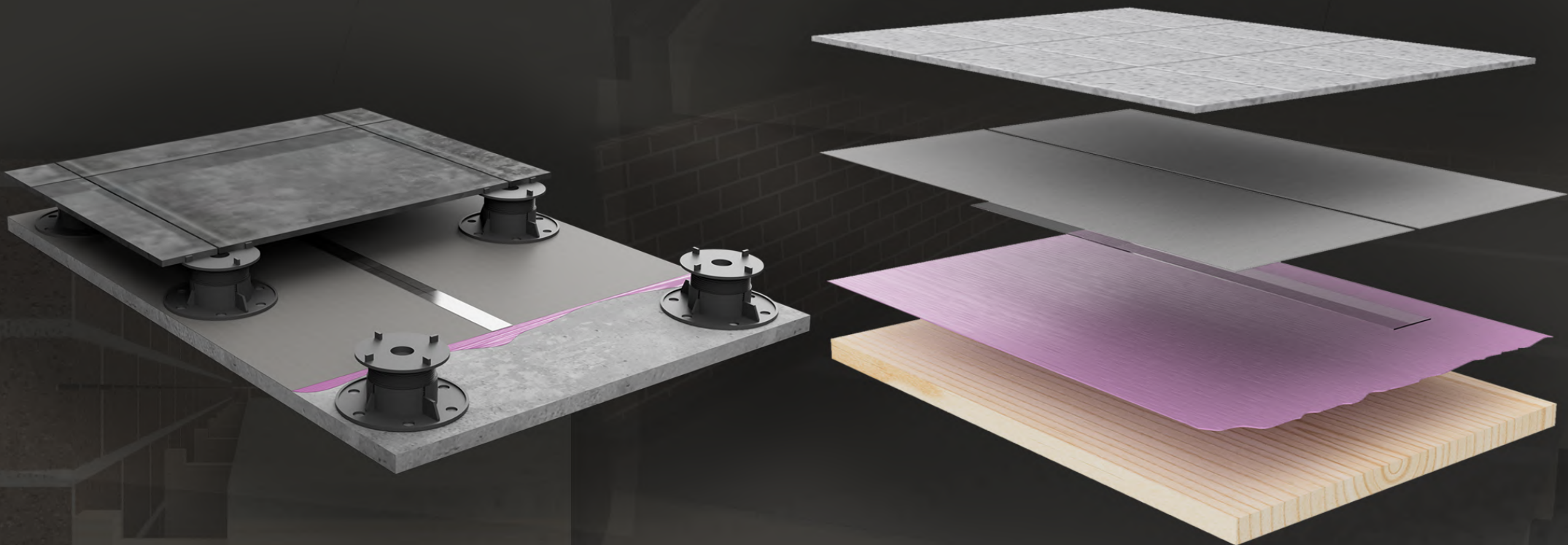

- REBATE FOR DRAIN
- REBATE FOR FLASHING
- REBATE FOR WATERPROOFING

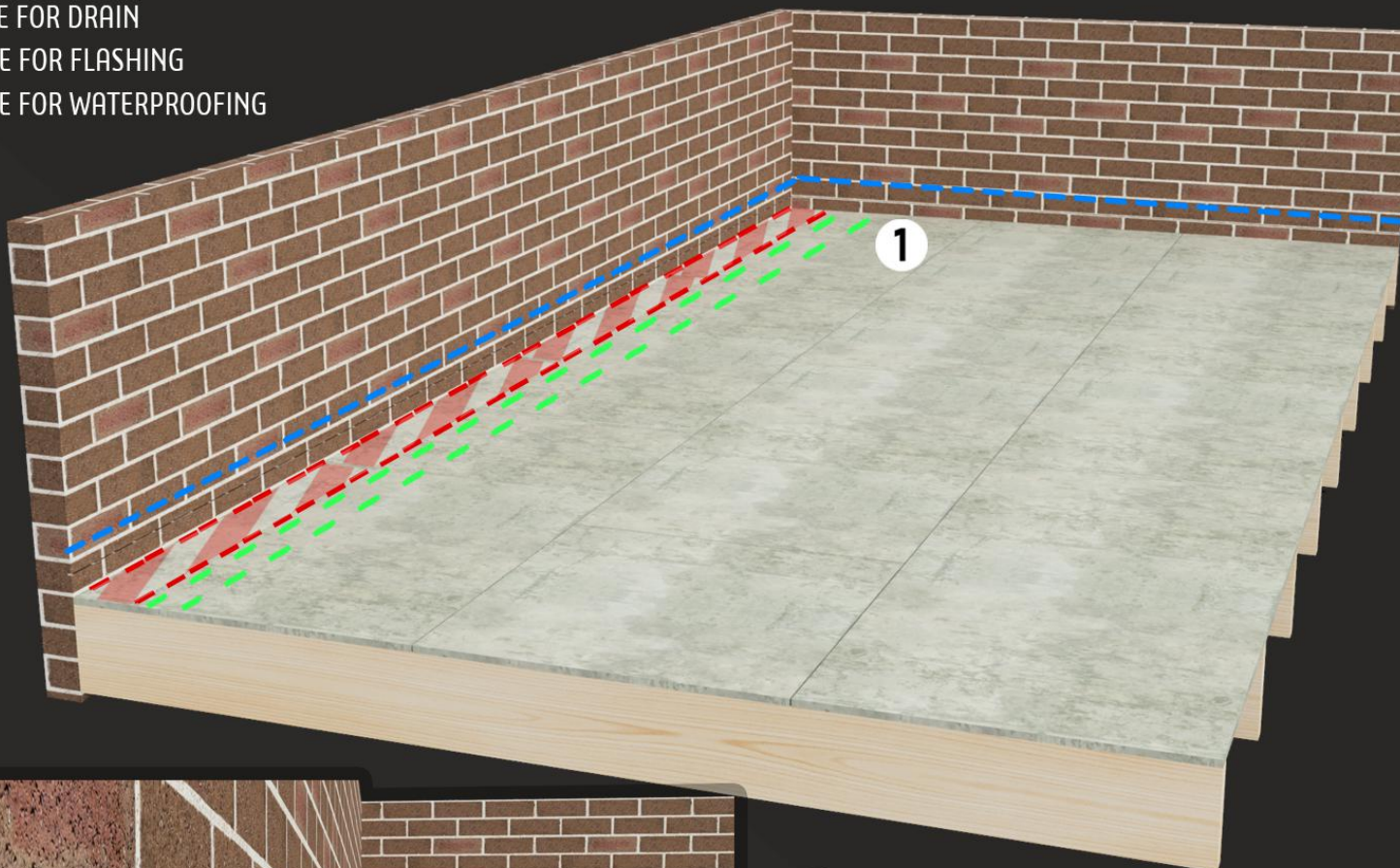

1

SETUP FOR DRAIN INSTALLATION STEP 1

*Setting up to install your lineal drain
 Mark out the area to be cut out to
 fit the drain also mark out for
 cut into the wall for Australian Standards
 Termination Flashing down over PDQ POLY*

Cut to Brickwork, should be approx
 80 mm above the floor for
 waterproofing to come up to around
 70 mm and have the over flashing re
 turn back down approx 30 mm.
 Cut into the wall should be around
 12 to 15 mm deep

2

HANDY HINTS

*Prior Planning to Build the Fall into your Deck area is the
 most cost effective method . Eliminates the need to
 screed. Your falls Eliminates excessive Weight and Having to
 Waterproof again Over Your Screed.*



2

CUTTING REBATE STEP 2

Proceed to cut out flooring to insure
 your lineal drain will fit.
 Whilst the drain is in Place Mark along
 drain flashing to grind the sheeting
 down and have the floor flashing sit flush
 with the top of the sheet

TOOLS REQUIRED

BROOM
DUSTPAN AND BRUSH
VACUUM
SAW

OPTIONAL;
BUCKET AND MOP

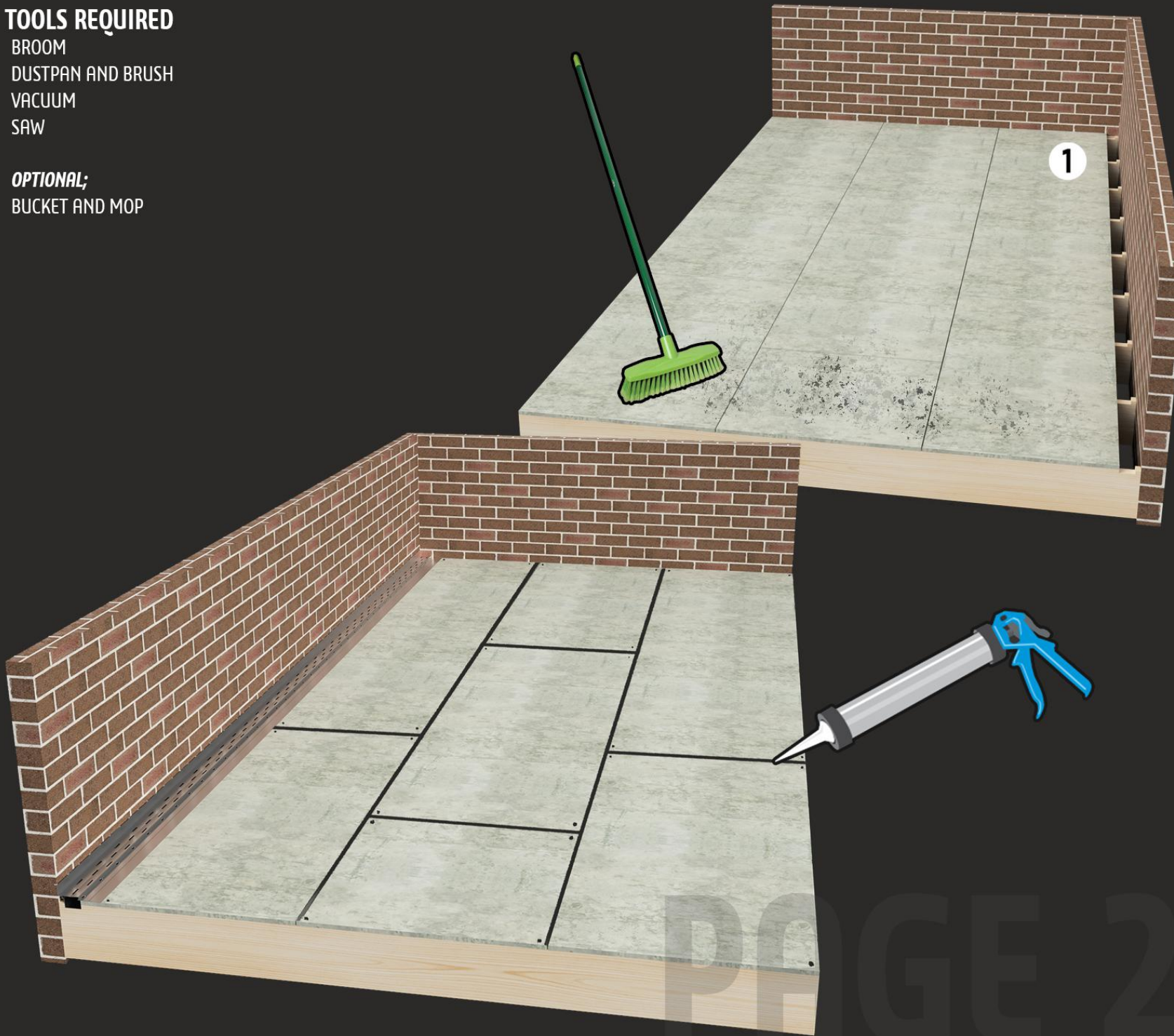

1

CLEAN AREA

STEP 3

After Cutting the Termination Slot into the Walls and removing the floor area required to fit your drain, it is **IMPORTANT** to Clean the Floor area Ready to prepare for the installation of your drain and **PDQ POLY MEMBRANE**

GUIDE

Sweep or Vacuum soiled floor area, and wash Floor area if Required to have the Surface Nice and Clean ready to prime With PDQ purple primer.

2

FILL SEAMS WITH SMX-50

STEP 4

Once Floor is Clean, fill all Scyon Sheet Joins with SMX-50 Polymer Sealant. Including Wall to Floor Sheeting Joins

PAGE 2

CDS GRATE OPTIONS

BAR GRATE

TILE INSERT GRATE

PUNCH SLOT GRATE

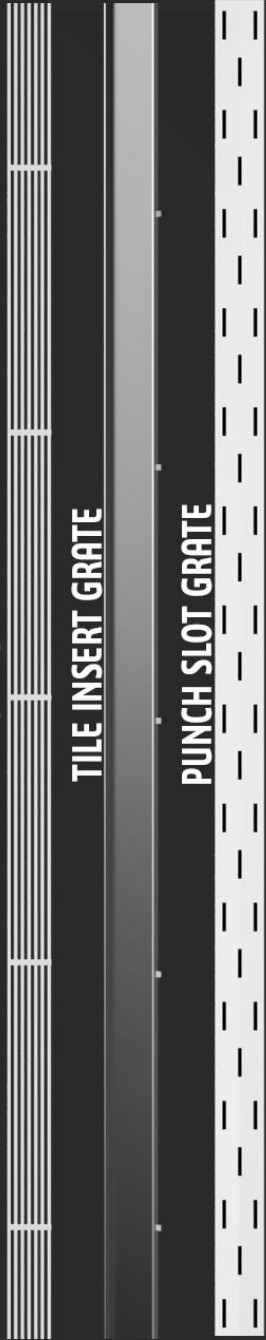

1



2



CREATIVE
DRAIN
SOLUTIONS

PREMIUM SELF ADHESIVE
PDO POLY
WATERPROOF MEMBRANE / UNDERLAY / ISOLATION BARRIER

1

APPLY SMX-50 PART 5

Caulk Wall and Edge of
Scyon Sheeting with a minimum
of 4 lines of SMX-50.

2

INSTALL DRAIN PART 6

Place CDS Drain into rebate and push
down to evenly distribute Polymer.

Screw down the drain in the
designated punch slot points
(Make sure you use Stainless Steel
Screws to prevent corrosion)

PAGE 3

TOOLS REQUIRED

PAINT ROLLER

PAINT TRAY

PDQ POLY PURPLE PRIMER (SUPPLIED)



PDQ PURPLE PRIMER

Q: 2500ml

1

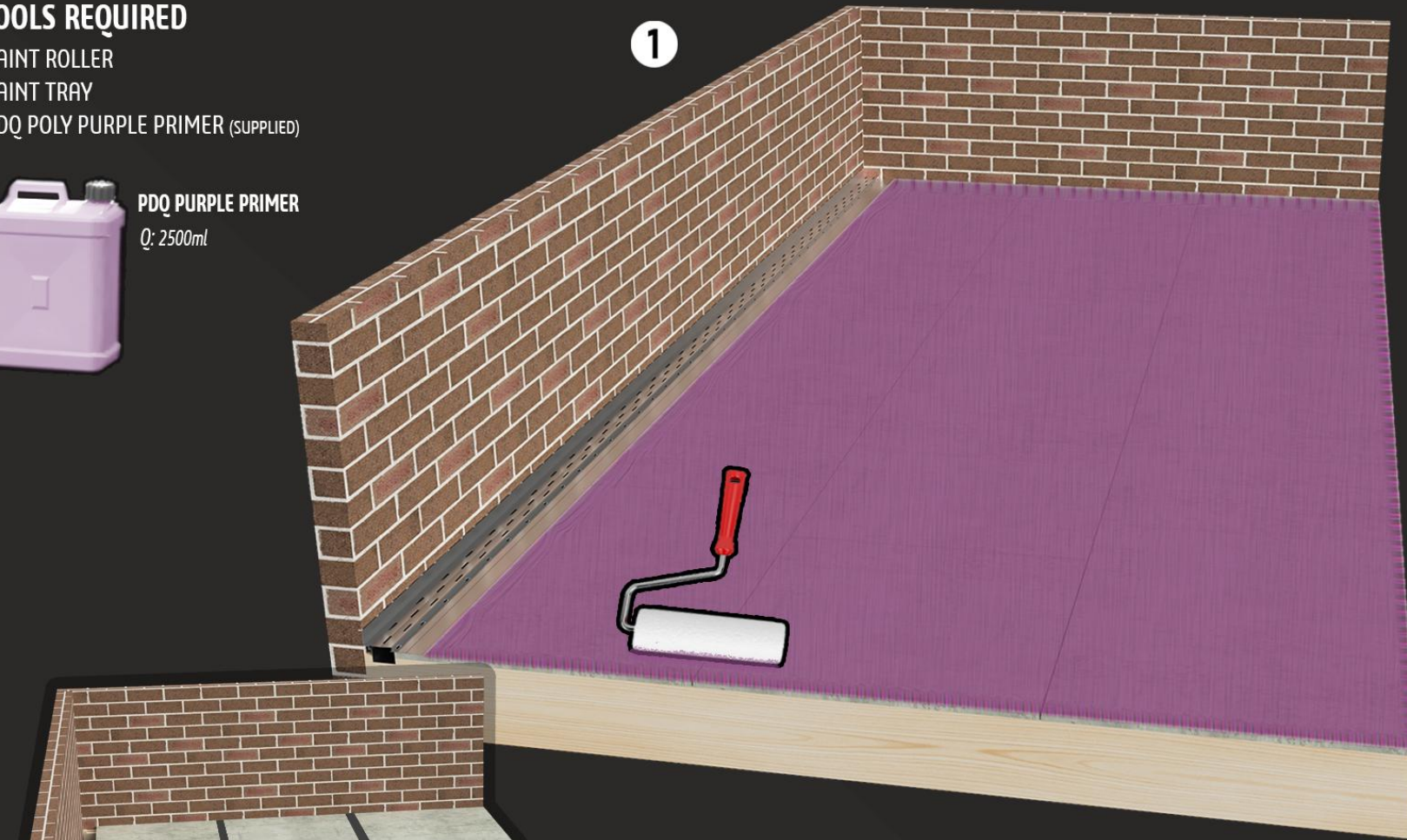

2

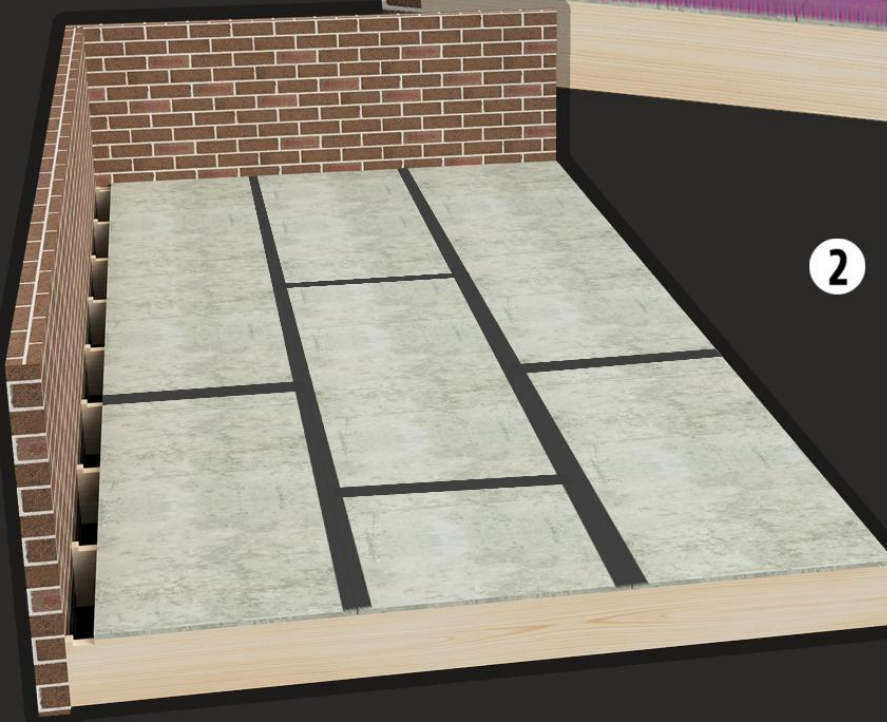

PREMIUM SELF ADHESIVE

PDQ POLY

WATERPROOF MEMBRANE / UNDERLAY / ISOLATION BARRIER

1

PAINT ON PDQ POLY STEP 7

Prime Floor Area with PDQ Purple
Primer PDQ primer dries very
Quickly allowing for further works to
continue.

*In Extreme hot Weather
PDQ Pink Additive Can be Used to
dilute the PDQ*

2

LAY BOND BREAKER STEP 8

Apply Bond Breaker Tape overall
joints to allow for expansion
and contraction Of The Sheeting.

PAGE 4

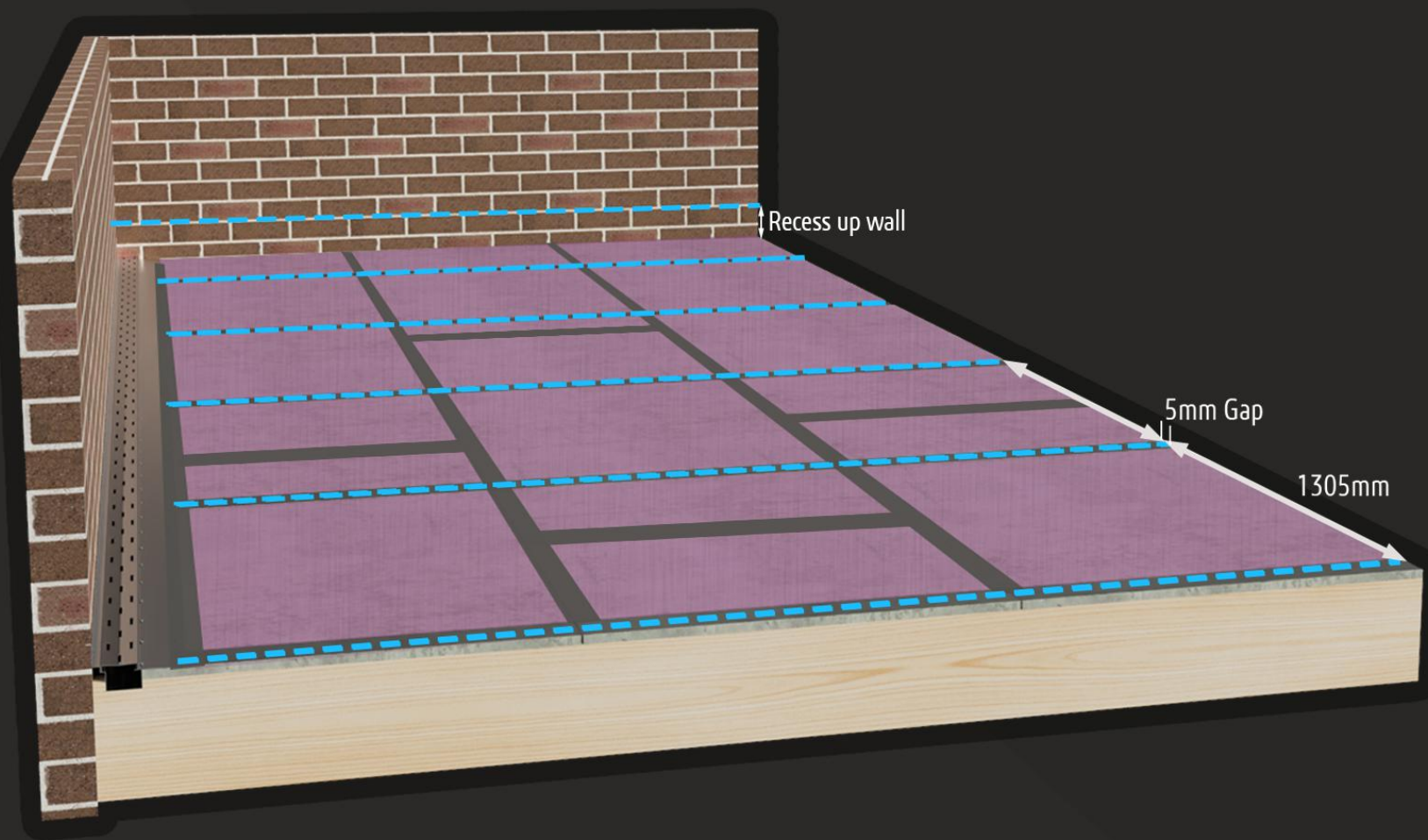

1

PDQ

PREPERATION

STEP 9

Setting out the PDQ poly and applying the BASE Joint Tape for Maximum Adhesion of sheet Joins. Allow around a 5mm gap between sheets, Once you have set out the sheet sizes you can Apply the base Joint Tape ready to lay your PDQ POLY SHEETING.

TOOLS REQUIRED

PDQ POLY WATERPROOFING MEMBRANE (SUPPLIED)

BOND BREAKER TAPE (SUPPLIED)

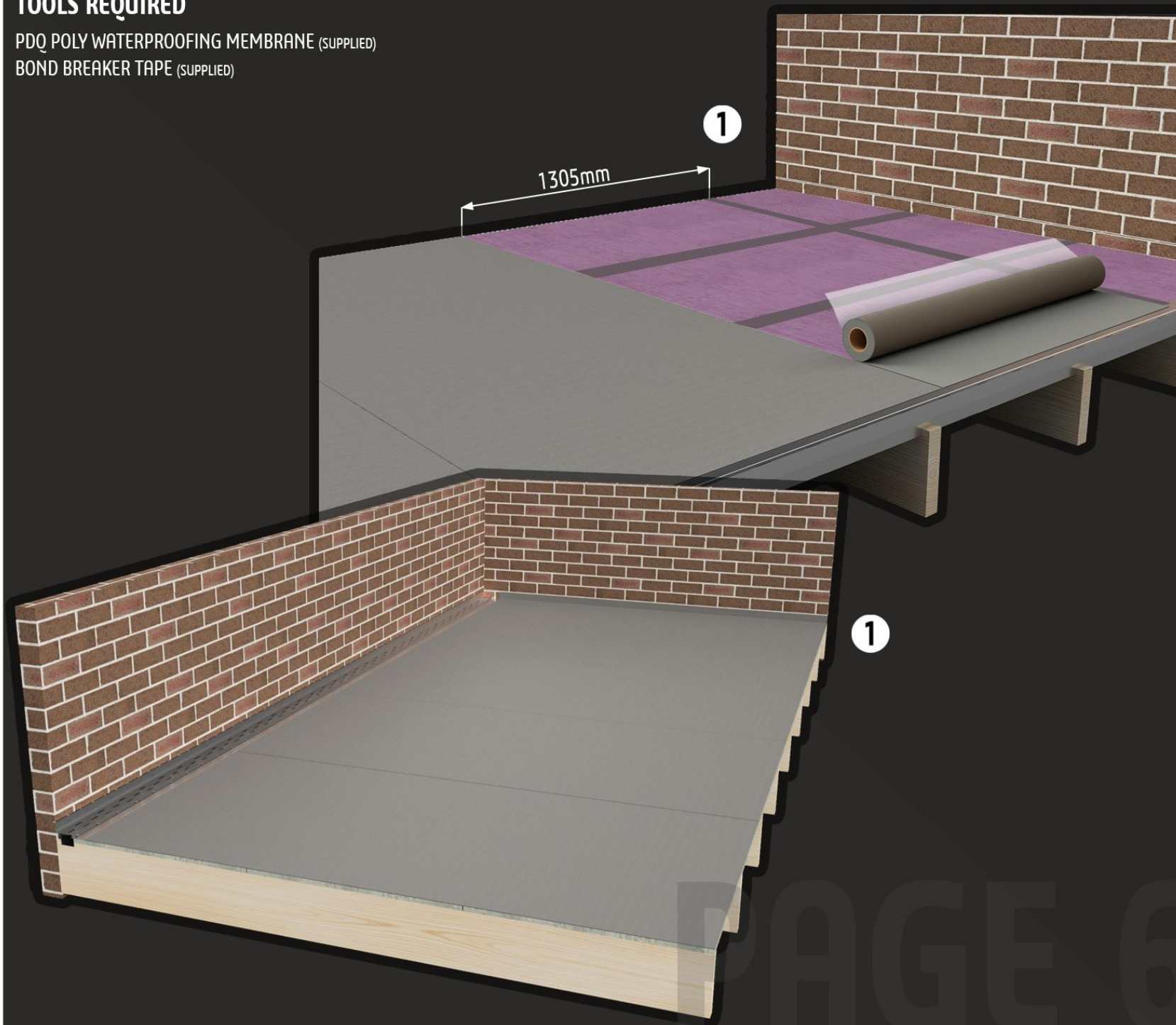

1

LAY PDQ POLY PART 10

Set up your PDQ POLY Sheeting and peel back & adhere around 100 mm of the sheet and make sure it will roll out nice and square. Continue to peel the backing sheet off and adhere the sheet to the floor Smoothing it out with a Flat round edge trowel Or a block of Wood.

1

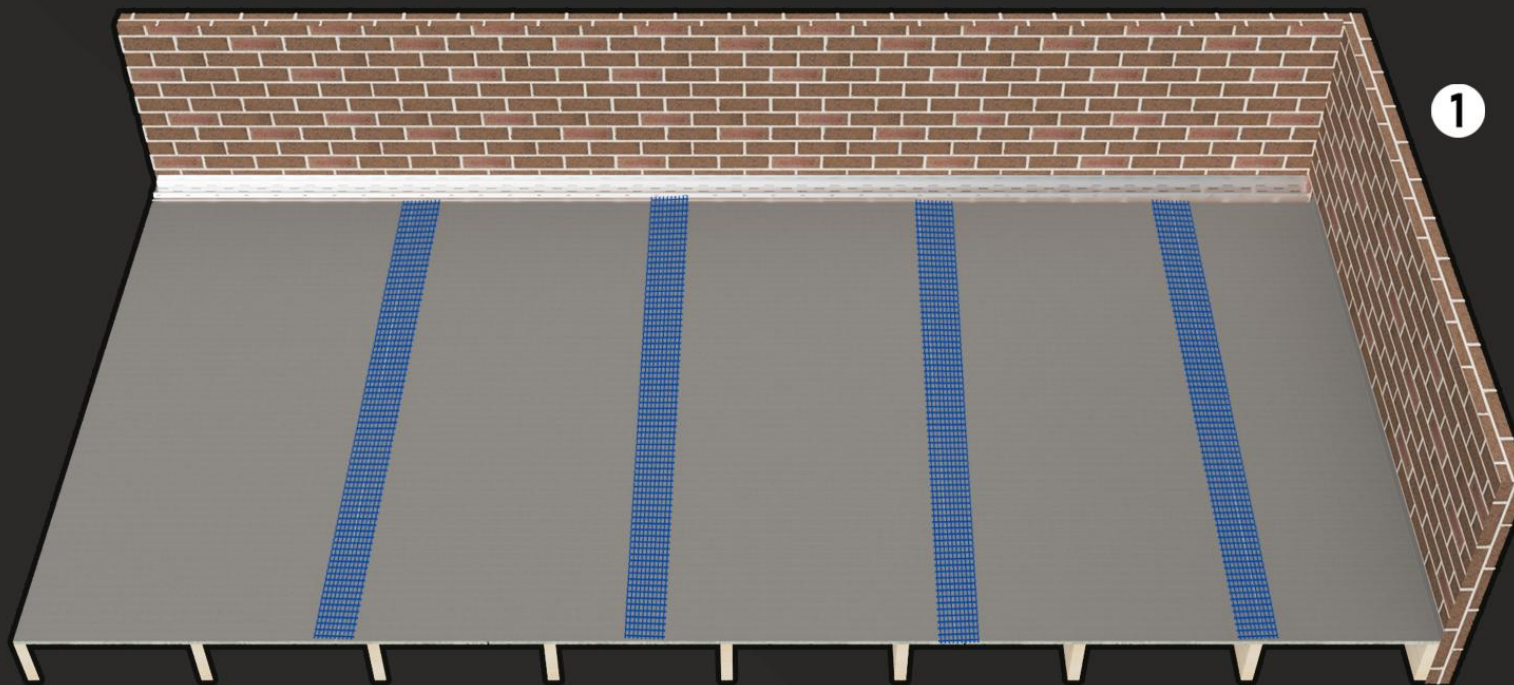

1
**SELF ADHESIVE
FIBRE**
STEP 11

Apply the Self Adhesive Fibre reinforced Tape over the center of the joints pressing it into Position as you go.

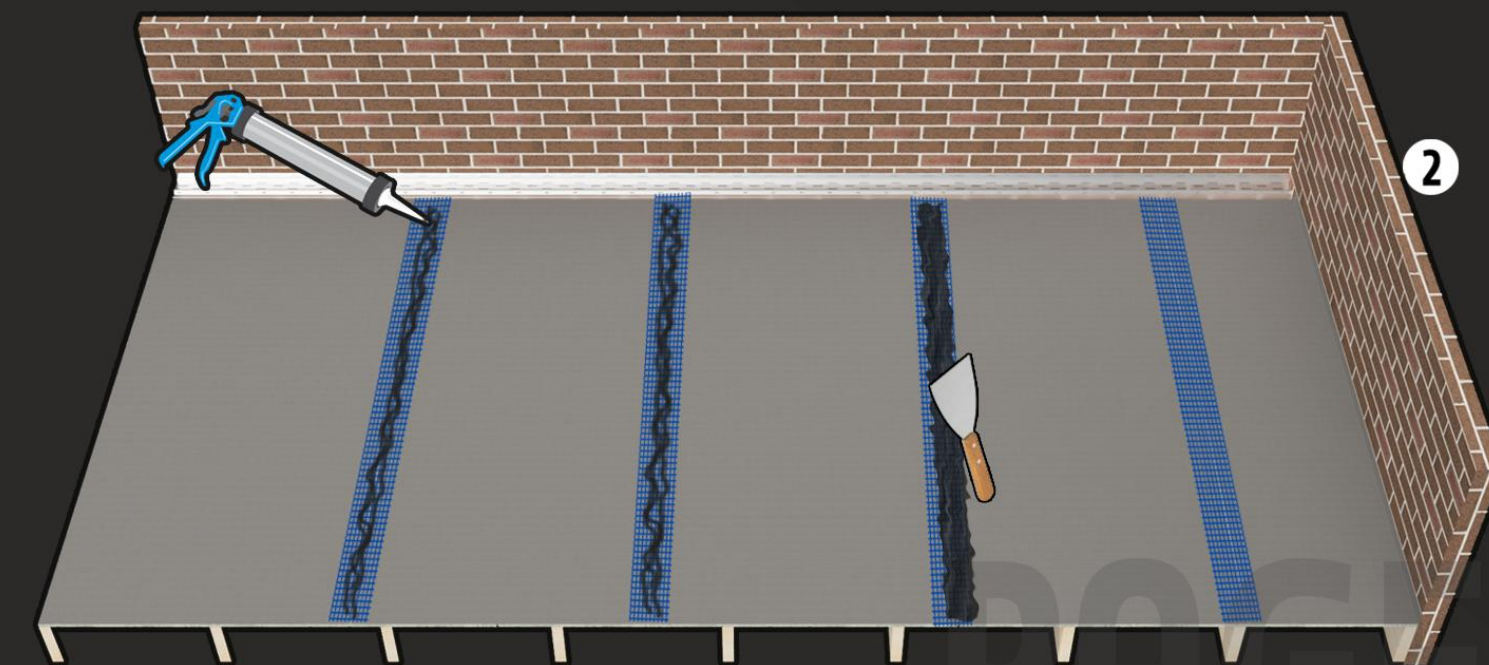

2
APPLY SMX-50
STEP 12

Apply 3 runs of SMW-50 Polymer along the Joints and trowel it down to be nice and smooth covering all of the fiber tape and to have it around 75 mm wide.

1



1

CDS DRAIN TERMINATION STEP 13

Addressing Termination to Stainless Steel
Drain Flashing.

DO NOT PRIME THE STAINLESS STEEL.

Clean with Acetone or Similar Cleaner Only.

Adhere around 40 mm of the
PDQ POLY sheet to the stainless
steel edge of the drain.

if you wish to be doubly sure of your
seal to the Stainless steel apply a neat
bead along the edge of

the sheet before fitting it down to
the drain flashing .then once applied run
a band of the blue fiber mesh tape over
the PDQ poly sheet edge and onto
the flashing of the DRAIN then apply
SMX-50 Polymer over the two
edges and trowel
down nice and smooth.

1

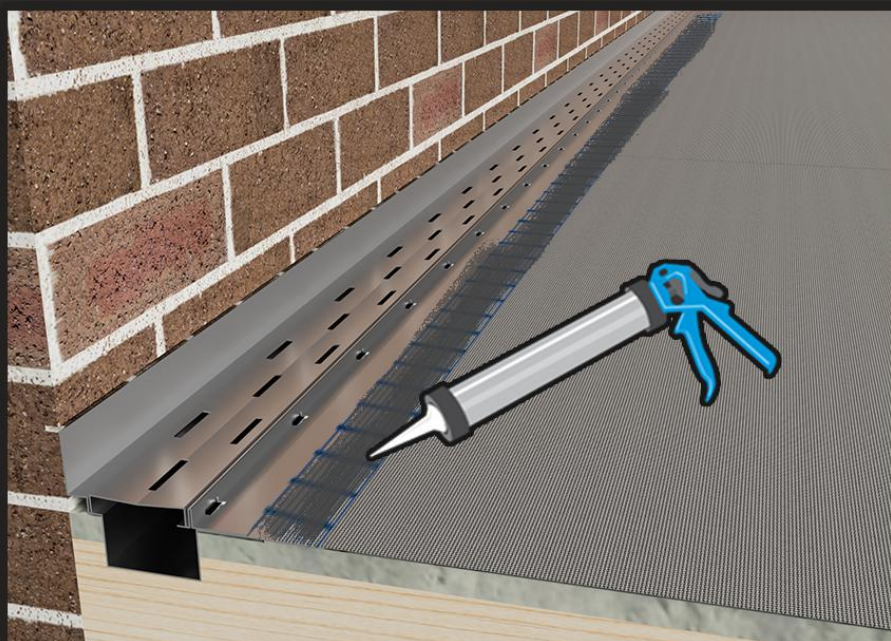
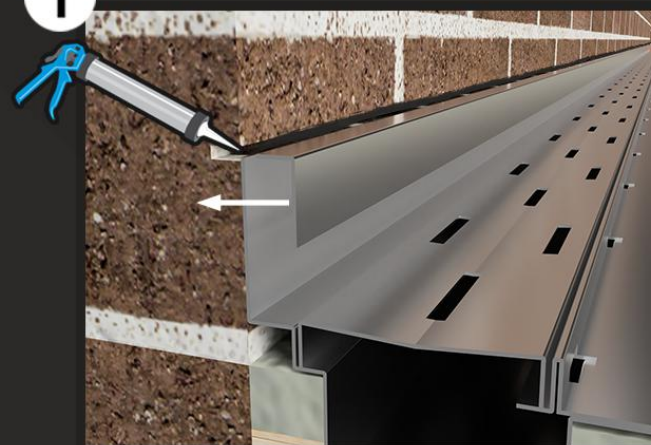

PAGE 8

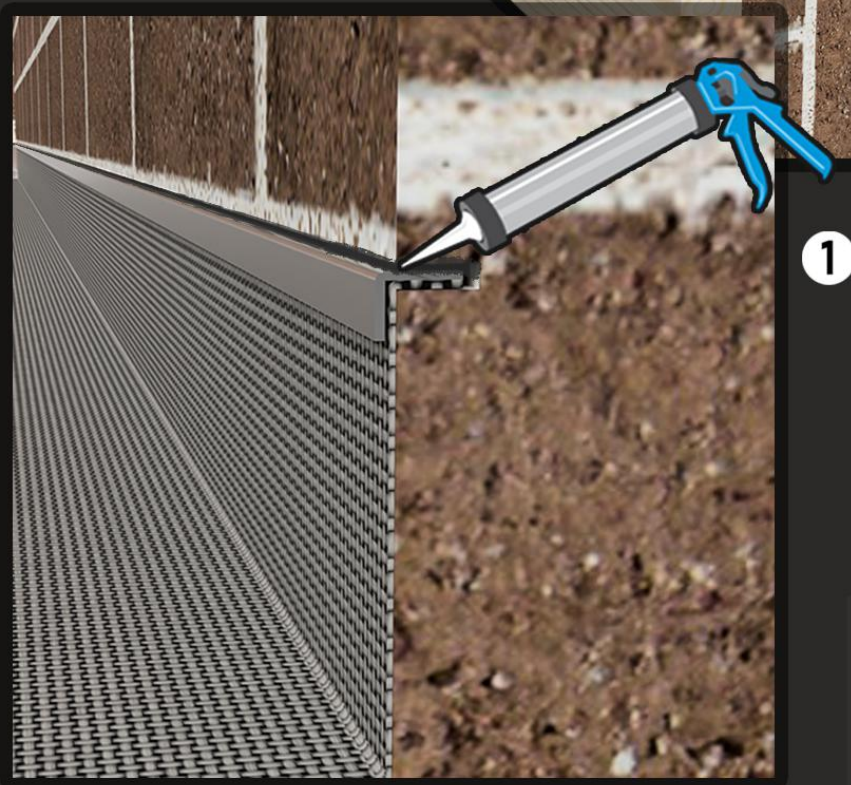
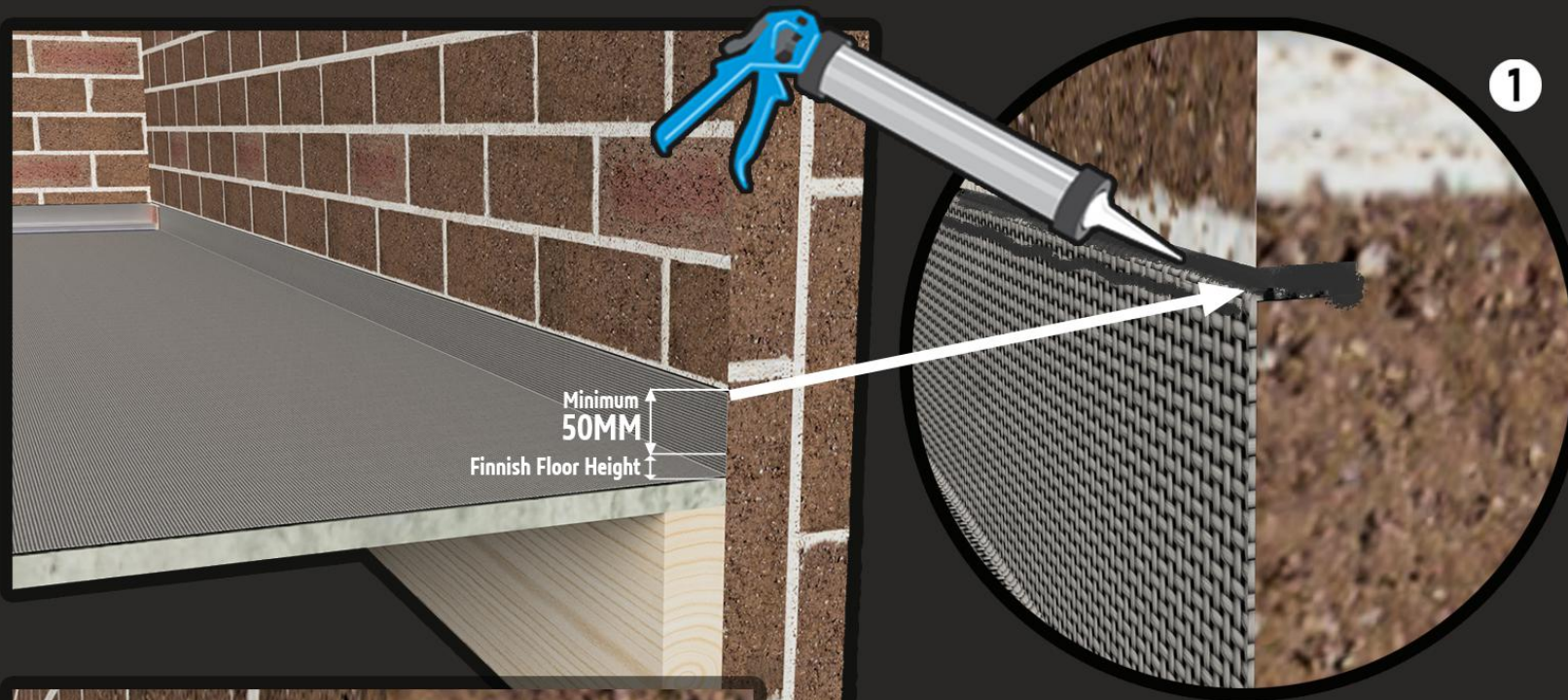

1 AUS STANDARDS TERMINATION STEP 14

Insure You return the PDQ poly up the wall areas to finish a Minimum of 50 mm above Finished Floor Tile Height. Seal the top of the sheeting off with an angle back into the wall joint you had Previously Cut. Be Sure to fill the joint with SMX-50 polymer sealant to seal up to meet the Australian Standards Termination.

Once this has Dried you are Ready to Start Tiling